

www.choiceeducation.org

BIG DREAMS START HERE.

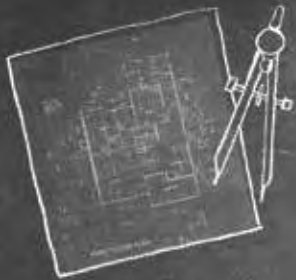

architect

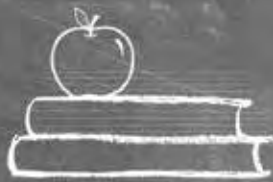

teacher



artist

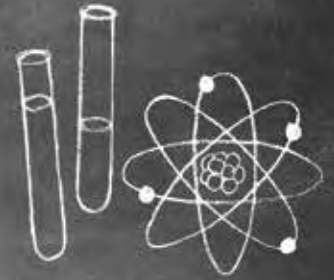

scientist



2017-2018 RSCO CATALOG



Lottery Placement Procedures

The RSCO lottery may use one or more of these procedures to place students in the Open Choice program or a magnet school. Please refer to the table that follows this page for procedures specific to a school.

Reminder: On the RSCO lottery application you may select up to five magnet schools and/or up to five Open Choice districts/schools, but your student may only receive one placement offer through the regular lottery process. If your student is offered a placement in one of the magnet schools selected in your application, he/she will be removed from all remaining magnet school and Open Choice waitlists. If your student receives an Open Choice placement offer, he/she will be removed from all magnet school waitlists.

No procedure listed in this catalog guarantees placement in the Open Choice program or a magnet school.

Note: RSCO defines a sibling as a brother or sister living in the same house and sharing at least one biological parent or legal guardian.

Hartford Region Open Choice Program

Applicant Sibling: When RSCO offers an applicant an Open Choice seat, RSCO may also offer an Open Choice seat to a sibling or siblings who also applied to the Open Choice program in that district.

Enrolled Sibling: When a seat is available, on-time applicants who already have a sibling enrolled in the Open Choice Program are given preference for a placement in the town in which that sibling attends school.

Open Choice Only: RSCO lottery applicants who select only the Open Choice Program on the RSCO lottery application receive a preference if seats are available.

Participation Rate: Applicants who live in towns other than Hartford with lower rates of participation in school choice options, will receive preference over those students who live in towns with higher rates of participation.

Residential Zone: Hartford-resident applicants may select and rank up to five (5) suburban public school districts in their residential zone. These ranked selections will be used for placement purposes.

Magnet Schools

Enrolled Sibling: Applies when an applicant has applied to the same school that another sibling will continue to attend in the 2017–2018 school year. **If a magnet school placement is offered to, and accepted by, a sibling of an enrolled student, it is expected that both students attend the magnet school for the entire 2017–18 school year. To receive this preference, the attending sibling must be verified on the applicant's RSCO lottery application prior to the RSCO lottery being conducted.**

Neighborhood: Applies only to Hartford resident students living within a half-mile (0.5) radius of specified schools.

Parent Choice: Magnet schools that have partnership agreements with partnering school districts/towns may decide to admit students who do not live in those partnership towns. Such schools are not required to admit students from non-partnership towns.

Participation Rate: Applicants who live in towns other than Hartford, with lower rates of participation in school choice options, will receive preference over those students who live in towns with higher rates of participation.

Partner Districts/Towns: Some school districts and towns have a partnership agreement with a magnet school to send specific numbers of students to that school. If schools participate in the state's Parent Choice process, placement is not limited to students living in partner districts/towns, and any interested student may apply.

School Pathways: Applies when a school sets aside a limited number of seats for students coming from a lower grade magnet school. **A pathway is not a guarantee of placement.**

Staff: Applies to children of employees, employed at the selected school (including teachers and other school-based staff).

Zones: Applies to Hartford resident students living in specific Hartford school zones and applying to certain schools, as follows:

- Zone 1 and applying to Montessori Magnet at Annie Fisher, STEM at Annie Fisher, Noah Webster MicroSociety, Hartford Pre-K Magnet and Breakthrough II
- Zone 2 and applying to Capital Preparatory Magnet School (Grades PK3–Grade 5 only)
- Zone 3 and applying to Breakthrough Magnet, Environmental Sciences at Mary Hooker, and Montessori at Moylan
- Zone 4 and applying to R.J. Kinsella Magnet School of the Performing Arts (PK4–8), Betances ERL

Lottery Placement Procedures

Please use the chart below as part of making an informed decision. Procedures and pathways are not a guarantee of placement. Pathway placements are made on a space-available basis, after other preferences (if offered). Chart subject to change based on seat availability.

Programs/Schools	Placement Procedures	Pathways From	Pathways To
Hartford Region Open Choice Program	<ul style="list-style-type: none"> • Applicant Sibling • Enrolled Sibling • Open Choice Only • Participation Rate • Residential Zone 		
Academy of Aerospace & Engineering (AAE-Elem)	<ul style="list-style-type: none"> • Partner District • Sibling • Staff 	<ul style="list-style-type: none"> • Hartford Pre-K Magnet • Preschool at ASI 	
Academy of Aerospace & Engineering (AAE) (6–12)	<ul style="list-style-type: none"> • Sibling • Staff 	<ul style="list-style-type: none"> • CREC schools ending in Grade 5* • CMMS 	
Betances Early Reading Lab	<ul style="list-style-type: none"> • Neighborhood • Sibling • Staff • Zone 4 (Hartford) 	<ul style="list-style-type: none"> • Hartford Pre-K Magnet 	<ul style="list-style-type: none"> • Betances STEM
Betances STEM	<ul style="list-style-type: none"> • Sibling • Staff • Zone 4 (Hartford) 	<ul style="list-style-type: none"> • Betances ERL 	<ul style="list-style-type: none"> • Pathways Academy
Breakthrough Magnet School South Campus (Breakthrough South)	<ul style="list-style-type: none"> • Neighborhood • Sibling (only PK3 and PK4) • Staff • Zone 3 (Hartford) 	<ul style="list-style-type: none"> • Hartford Pre-K Magnet 	<ul style="list-style-type: none"> • CT IB Academy • CT River Academy • Great Path • Pathways Academy • R.J. Kinsella • SMSA • University High School
Breakthrough II Magnet School	<ul style="list-style-type: none"> • Neighborhood • Sibling (only PK3 and PK4) • Staff • Zone 1 (Hartford) 	<ul style="list-style-type: none"> • Hartford Pre-K Magnet 	<ul style="list-style-type: none"> • Great Path • Pathways Academy • R.J. Kinsella • SMSA • University High School
Capital Community College Magnet Academy	<ul style="list-style-type: none"> • Sibling • Staff 		
Capital Preparatory Magnet School—Lower School Program	<ul style="list-style-type: none"> • Neighborhood • Staff • Zone 2 (Hartford) 	<ul style="list-style-type: none"> • Hartford Pre-K Magnet 	
Capital Preparatory Magnet School—Upper School Program	<ul style="list-style-type: none"> • Staff 	<ul style="list-style-type: none"> • Montessori at Annie Fisher 	
Classical Magnet School	<ul style="list-style-type: none"> • Sibling • Staff 	<ul style="list-style-type: none"> • CMMS • Discovery Academy • GEHMS • IMS • Montessori at Annie Fisher • Noah Webster • Museum Academy • Reggio Magnet • UHMS 	

* CREC schools ending in Grade 5: Discovery, GEHMS, IMS, Museum, Reggio, UHMS

** CREC schools beginning in Grade 6: AAE, GHAA, ASI, MLC, TRMMS

*** CREC schools offering Kindergarten: AAE-Elem, Ana Grace, CMMS, Discovery, GEHMS, IMS, Museum, Reggio, UHMS

Programs/Schools	Placement Procedures	Pathways From	Pathways To
Connecticut IB Academy	<ul style="list-style-type: none"> • Partner Districts • Sibling 	<ul style="list-style-type: none"> • Breakthrough South 	
Connecticut River Academy at Goodwin College	<ul style="list-style-type: none"> • Sibling • Staff 	<ul style="list-style-type: none"> • Breakthrough South • Environmental Sciences at Mary Hooker • TRMMS 	
CREC Ana Grace Academy of the Arts	<ul style="list-style-type: none"> • Sibling • Staff 	<ul style="list-style-type: none"> • Hartford Pre-K Magnet • Preschool at ASI 	
CREC Greater Hartford Academy of the Arts—Full-Day (GHAA-FD)	<ul style="list-style-type: none"> • Sibling • Staff 	<ul style="list-style-type: none"> • CREC schools ending in Grade 5* • GHAA-HD • CMMS 	
CREC Greater Hartford Academy of the Arts—Half-Day (GHAA-HD)	<ul style="list-style-type: none"> • Partner Districts • Sibling • Staff 		<ul style="list-style-type: none"> • GHAA-FD
CREC Montessori Magnet School (CMMS)	<ul style="list-style-type: none"> • Neighborhood • Sibling • Staff 	<ul style="list-style-type: none"> • Hartford Pre-K Magnet • Preschool at ASI 	<ul style="list-style-type: none"> • CREC Schools beginning in Grade 6** • Classical Magnet • SMSA • TRMMS
Discovery Academy	<ul style="list-style-type: none"> • Partner District • Sibling • Staff 	<ul style="list-style-type: none"> • Hartford Pre-K Magnet • Preschool at ASI 	<ul style="list-style-type: none"> • CREC schools beginning in Grade 6** • Classical Magnet • The Global Experience Magnet School • SMSA
Environmental Sciences Magnet School at Mary Hooker	<ul style="list-style-type: none"> • Neighborhood • Sibling • Staff • Zone 3 (Hartford) 		<ul style="list-style-type: none"> • CT River Academy • Great Path • Pathways Academy • R.J. Kinsella • University High School
Glastonbury-East Hartford Magnet School (GEHMS)	<ul style="list-style-type: none"> • Partner Districts • Sibling • Staff 	<ul style="list-style-type: none"> • Hartford Pre-K Magnet • Preschool at ASI 	<ul style="list-style-type: none"> • CREC schools beginning in Grade 6** • Classical Magnet • The Global Experience Magnet School • SMSA
The Global Experience Magnet School	<ul style="list-style-type: none"> • Sibling • Staff 	<ul style="list-style-type: none"> • CREC schools ending in Grade 5* 	
Great Path Academy at Manchester Community College	<ul style="list-style-type: none"> • Sibling • Staff 	<ul style="list-style-type: none"> • Breakthrough South • Breakthrough II • Environmental Sciences at Mary Hooker • HMTCA • Noah Webster • Renzulli Gifted & Talented • STEM at Annie Fisher 	
Hartford Magnet Trinity College Academy (HMTCA)	<ul style="list-style-type: none"> • HMTCA and Trinity College staff • Sibling • Staff 		<ul style="list-style-type: none"> • Great Path • Pathways Academy • SMSA • University High School

* CREC schools ending in Grade 5: Discovery, GEHMS, IMS, Museum, Reggio, UHMS

** CREC schools beginning in Grade 6: AAE, GHAA, ASI, MLC, TRMMS

*** CREC schools offering Kindergarten: AAE-Elem, Ana Grace, CMMS, Discovery, GEHMS, IMS, Museum, Reggio, UHMS

Programs/Schools	Placement Procedures	Pathways From	Pathways To
Hartford Pre-K Magnet School	<ul style="list-style-type: none"> • Neighborhood • Sibling • Staff • Zone 1 (Hartford) 		<ul style="list-style-type: none"> • Betances ERL • Breakthrough South • Breakthrough II • Capital Prep. Lower • CREC schools offering Kindergarten*** • R.J. Kinsella • STEM at Annie Fisher • Noah Webster
International Magnet School for Global Citizenship (IMS)	<ul style="list-style-type: none"> • Sibling • Staff 	<ul style="list-style-type: none"> • Hartford Pre-K Magnet • Preschool at ASI 	<ul style="list-style-type: none"> • CREC schools beginning in Grade 6** • Classical Magnet • The Global Experience Magnet School • SMSA
CREC Academy of Science and Innovation (ASI)	<ul style="list-style-type: none"> • Sibling • Staff 	<ul style="list-style-type: none"> • CREC schools ending in Grade 5* • CMMS 	
Metropolitan Learning Center (MLC)	<ul style="list-style-type: none"> • Partner Districts • Sibling • Staff 	<ul style="list-style-type: none"> • CREC schools ending in Grade 5* • CMMS 	
Montessori Magnet at Annie Fisher	<ul style="list-style-type: none"> • Neighborhood • Sibling • Staff • Zone 1 (Hartford) 	<ul style="list-style-type: none"> • Montessori Magnet at Moylan 	<ul style="list-style-type: none"> • Capital Prep Upper • Classical Magnet • SMSA • University High School
Montessori Magnet at Moylan	<ul style="list-style-type: none"> • Neighborhood • Sibling • Staff • Zone 3 (Hartford) 		<ul style="list-style-type: none"> • Montessori Magnet at Annie Fisher
Museum Academy	<ul style="list-style-type: none"> • Sibling • Staff 	<ul style="list-style-type: none"> • Hartford Pre-K Magnet • Preschool at ASI 	<ul style="list-style-type: none"> • CREC schools beginning in Grade 6** • Classical Magnet • The Global Experience Magnet School • SMSA
Noah Webster MicroSociety Magnet	<ul style="list-style-type: none"> • Neighborhood • Sibling • Staff • Zone 1 (Hartford) 	<ul style="list-style-type: none"> • Hartford Pre-K Magnet 	<ul style="list-style-type: none"> • Classical Magnet • Great Path • Pathways Academy • R.J. Kinsella • SMSA • University High School
Pathways Academy of Technology and Design	<ul style="list-style-type: none"> • Sibling • Staff 	<ul style="list-style-type: none"> • Betances STEM • Breakthrough South • Breakthrough II • Environmental Sciences at Mary Hooker • HMTCA • Noah Webster • STEM at Annie Fisher 	
Preschool at the CREC Academy of Science and Innovation (Preschool at ASI)	<ul style="list-style-type: none"> • Sibling • Staff 		<ul style="list-style-type: none"> • CREC schools offering Kindergarten***
Public Safety Academy (PSA)	<ul style="list-style-type: none"> • Sibling • Staff 		

* CREC schools ending in Grade 5: Discovery, GEHMS, IMS, Museum, Reggio, UHMS

** CREC schools beginning in Grade 6: AAE, GHAA, ASI, MLC, TRMMS

*** CREC schools offering Kindergarten: AAE-Elem, Ana Grace, CMMS, Discovery, GEHMS, IMS, Museum, Reggio, UHMS

Programs/Schools	Placement Procedures	Pathways From	Pathways To
Reggio Magnet School of the Arts	<ul style="list-style-type: none"> Sibling Staff 	<ul style="list-style-type: none"> Hartford Pre-K Magnet Preschool at ASI 	<ul style="list-style-type: none"> CREC schools beginning in Grade 6** Classical Magnet The Global Experience Magnet School SMSA
Riverside Magnet School at Goodwin College	<ul style="list-style-type: none"> Children of Goodwin College students, staff, and faculty Partner District Sibling Staff 		
R.J. Kinsella Magnet School of Performing Arts	<ul style="list-style-type: none"> Neighborhood Sibling Staff Zone 4 (Hartford) 	<ul style="list-style-type: none"> Breakthrough South Breakthrough II Environmental Sciences at Mary Hooker Hartford Pre-K Magnet Noah Webster STEM at Annie Fisher 	
STEM Magnet School at Annie Fisher	<ul style="list-style-type: none"> Neighborhood Sibling Staff Zone 1 (Hartford) 	<ul style="list-style-type: none"> Hartford Pre-K Magnet 	<ul style="list-style-type: none"> Great Path Pathways Academy R.J. Kinsella University High School
Sport and Medical Sciences Academy (SMSA)	<ul style="list-style-type: none"> Sibling Staff 	<ul style="list-style-type: none"> Breakthrough South Breakthrough II CMMS CREC schools ending in Grade 5* HMTCA Montessori Magnet at Annie Fisher Noah Webster 	
Two Rivers Magnet Middle School (TRMMS)	<ul style="list-style-type: none"> Partner Districts Sibling Staff 	<ul style="list-style-type: none"> CREC schools ending in Grade 5* CMMS 	<ul style="list-style-type: none"> CT River Academy TRHS
Two Rivers Magnet High School (TRHS)	<ul style="list-style-type: none"> Partner Districts Sibling Staff 	<ul style="list-style-type: none"> TRMMS 	
University of Hartford Magnet School (UHMS)	<ul style="list-style-type: none"> Neighborhood Partner Districts Sibling Staff 	<ul style="list-style-type: none"> Hartford Pre-K Magnet Preschool at ASI 	<ul style="list-style-type: none"> CREC schools beginning in Grade 6** Classical Magnet The Global Experience Magnet School SMSA
University High School of Science and Engineering	<ul style="list-style-type: none"> Sibling Staff 	<ul style="list-style-type: none"> Breakthrough South Breakthrough II Environmental Sciences at Mary Hooker HMTCA Montessori at Annie Fisher Noah Webster STEM at Annie Fisher 	
Wintonbury Early Childhood Magnet School	<ul style="list-style-type: none"> Children from Bloomfield requiring specialized instruction Partner Districts Sibling Staff 		

* CREC schools ending in Grade 5: Discovery, GEHMS, IMS, Museum, Reggio, UHMS

** CREC schools beginning in Grade 6: AAE, GHAA, ASI, MLC, TRMMS

*** CREC schools offering Kindergarten: AAE-Elem, Ana Grace, CMMS, Discovery, GEHMS, IMS, Museum, Reggio, UHMS

RSCO School/Program Options

Academic Year 2017-18

