

**Proposal**

Our proposal is for production of 'backyard barges' and their docking stations, which are intimate floatation platforms that travel down the length of the river and can be hired for any purpose or event, whether it be concerts, plays, birthday celebrations, weddings or pop-up businesses, and therefore produce a constantly adapting cultural landscape for each community to engage with.

**Considerations**

- Historical context (transport, fishing, entertainment)
- Sea level rise and climate change
- Lack of recreational and social spaces post-earthquake (urban abandonment)

**Goals**

- Fair opportunities and access for all people.
- People feel and are safe.
- Healthy environment, healthy minds
- Make the east full of life with amenities and activities.
- People are connected with their community, and connected to all the city
- Define a space that can change with the landscape and social atmosphere

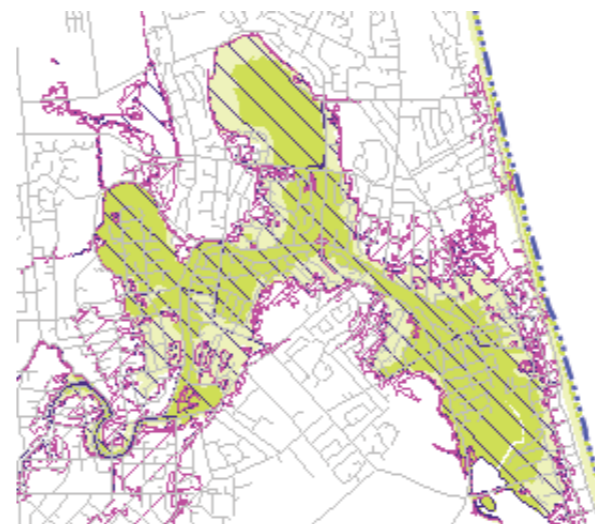
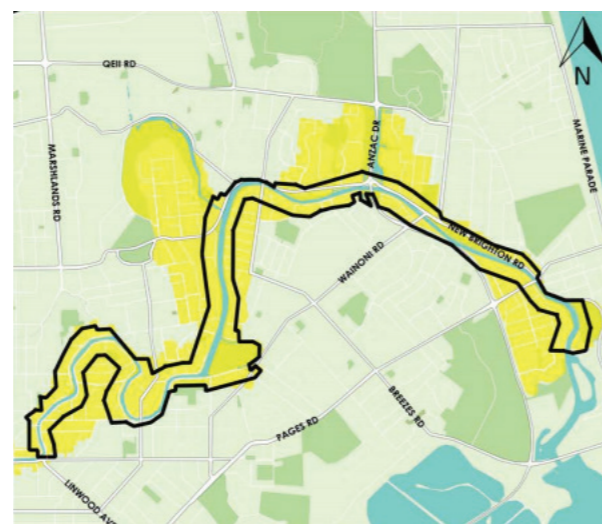
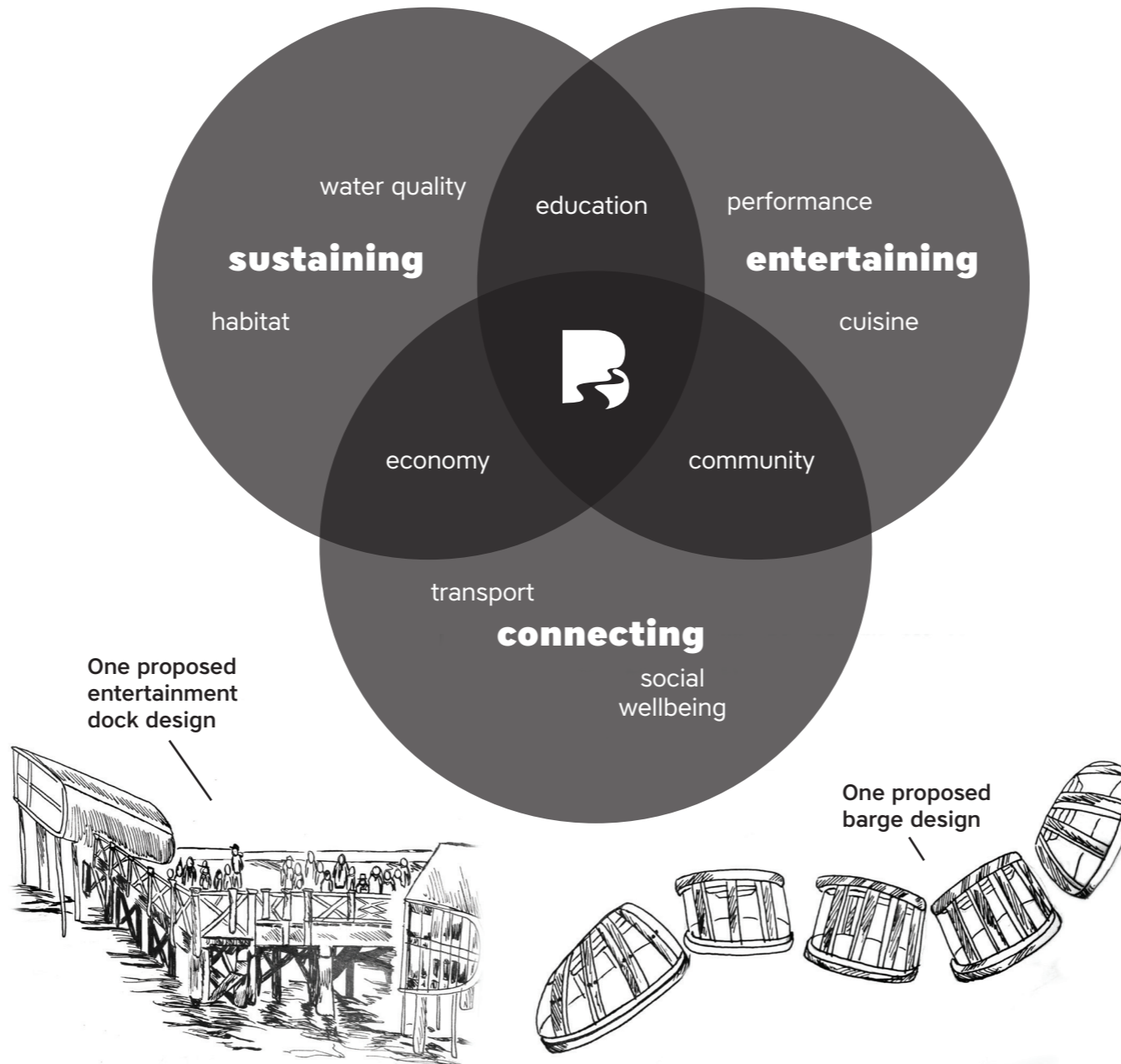

**The docks**

- Natural flora and fauna, Native breeding ground
- Live music, Performance spaces, Cuisine
- Sea to river, Young to old

**Energy**

In concern to powering the Backyard Barge, our plan is relatively simple. The barge will be run by an electric battery. Each of the docks along the river will have a number of similar electric batteries charging, so that when the Barge's battery begins to run out, it can easily swap it out for an already fully charged battery. Since the Barge will only need to really propel itself moving upstream, as the natural flow of the water will be able to move it downstream, these batteries should suffice in adequately powering the Barge.



**backyard  
barges**

*Giving you the kiwi  
backyard experience*

**Team Avon Haven**

**Greenspine. Christchurch**

Lewis, Jasmine, Sophie, Christine



**5**  
YEARS

**Entertaining Dock**

An outdoor entertainment unit comprised of bars, cafe's, an amphitheatre, terraced seating and a possible niche for passing barges to reside and conduct atmospheric performances on top of the river.

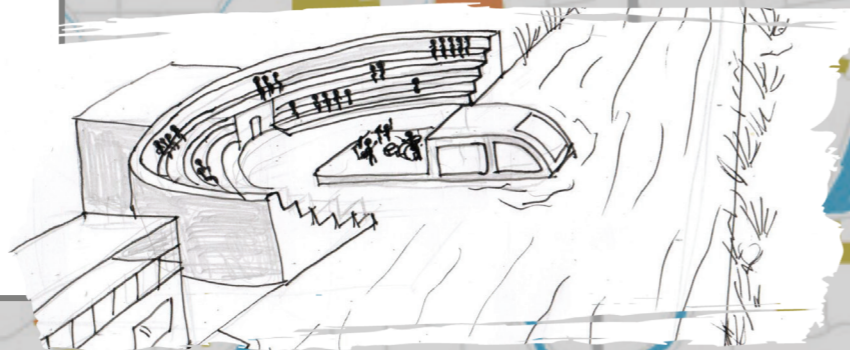

**25**  
YEARS

**Sustaining Dock**

Possibly constructed using fibrous organic materials, this dock would feature the deliberate plantation of native vegetation such as totara trees, kowhai, lancewood, flax, rushes and other shrubbery to provide a strong root system to stabilize the eroding river banks and a beautiful bush canopy that could act as a shared picnic or barbeque area and a setting for private events.

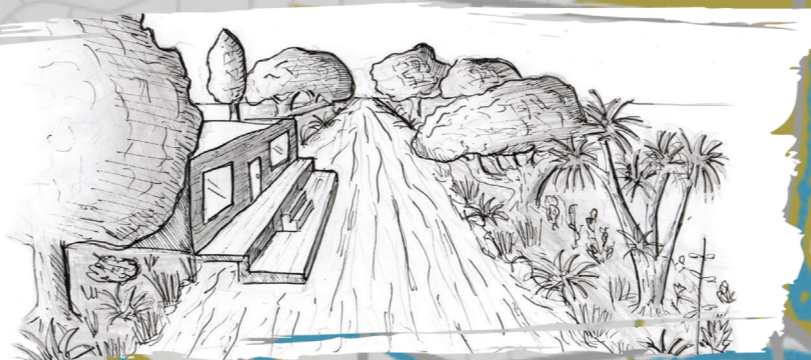

**50**  
YEARS

**Connecting dock**

Serves as both a recreational and sustainable connection that could serve as either an interactive water park for young families, an area where we could conduct our filtration idea by cultivating healthy marine life and shellfish or a fish-farming opportunity to create a network of estuaries and raise the population of native trout, whitebait and eels (especially that of the long-finned eel population) to be commercially sold or as an educative conservation project for children and adults alike.

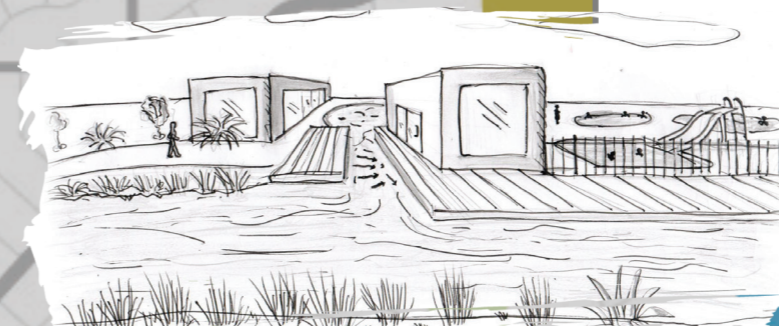

**URBAN  
NOW**

**COSTAL  
FUTURE**